



# MECHANICAL FITTINGS AND ACCESSORIES

## 151 3-piece straight connector, flat washer

### MECHANICAL FITTINGS AND ACCESSORIES



SIZE	PRESSURE	CODE	PACKING
1/2"	50bar/725psi	1510012	20/240
3/4"	40bar/580psi	1510034	15/135
1"	40bar/580psi	1510100	10/90
1"1/4	30bar/435psi	1510114	6/54
1"1/2	30bar/435psi	1510112	4/36
2"	25bar/362,5psi	1510200	2/24

### CERTIFICATIONS



### TECHNICAL SPECIFICATIONS

Suitable for domestic water services, heating and air-conditioning plants.

Body in brass.

Minimum and maximum working temperatures: -20°C, 120°C (in absence of steam).

Female threads: ISO228 (equivalent to DIN EN ISO 228 and BS EN ISO 228).

### OVERALL DIMENSIONS

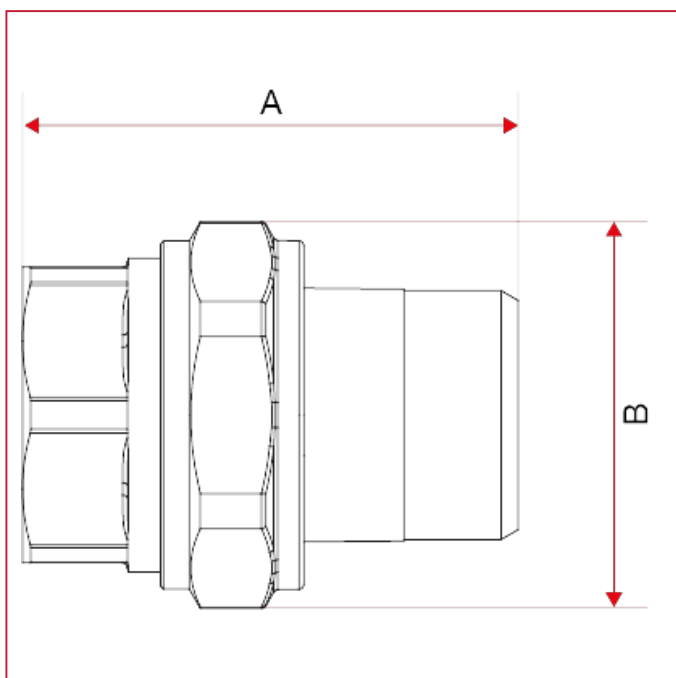



## MECHANICAL FITTINGS AND ACCESSORIES

	1/2"	3/4"	1"	1"1/4	1"1/2	2"
DN	15	20	25	32	40	50
A	47	52	61	69,5	74	78
B	33	40,5	49	55	69	87
Kg/cm2 bar	50	40	40	30	30	25
LBS - psi	725	580	580	435	435	362,5

### MATERIALS

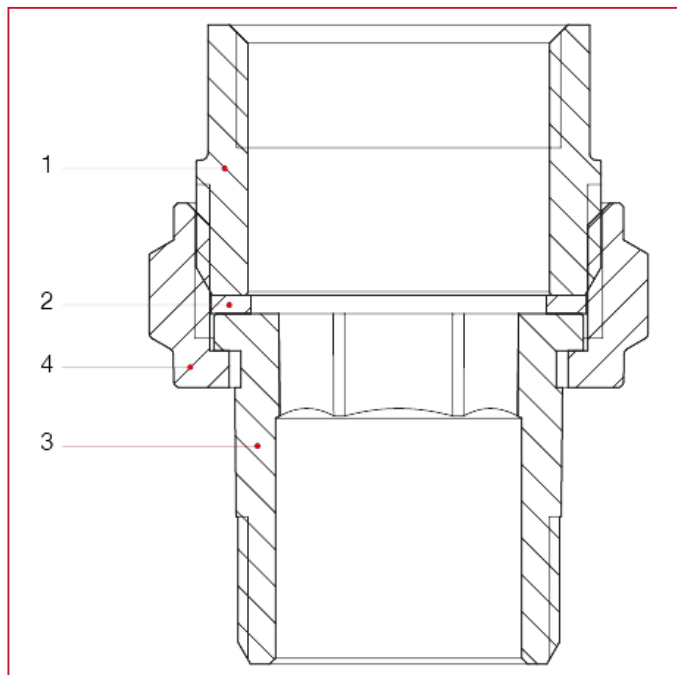

POS.	DESCRIPTION	N.	MATERIAL
1	Streight connector with flat seat	1	Brass CW617N
2	Flat seat washer	1	Fiber
3	Flat seat union	1	Brass CW617N
4	Nut	1	Brass CW617N